

Nautitech 46 Open



Year:	2018	Heads:	3
Location:	Preveza, Greece	Cabins:	3
LOA:	45' 3" (13.78m)	Berths:	7
LWL:		Displacement:	
Ballast:		Colour:	White
Designer:	Marc Lombard ...	Keel:	Twin Keel
Beam:	24' 9" (7.54m)	Engines:	2
Draft:	4' 9" (1.45m)		

Remarks:

The NAUTITECH OPEN 46 has been designed for people who love travelling on the sea.
THIS ONE IS FULLY LOADED Life aboard a NAUTITECH OPEN 46 is defined by comfort and plenty of space for spending relaxed hours at sea.
The Open version of this successful cruising catamaran features twin helms aft, a superb viewpoint for ocean

€520,000 Tax Not Paid

E: info@nyblefkas.com **T:** UK+ 44 203 051 0525 / Mob.+306945347870

networkyachtbrokers.com | over 700 boats listed

REF: 22F8484733

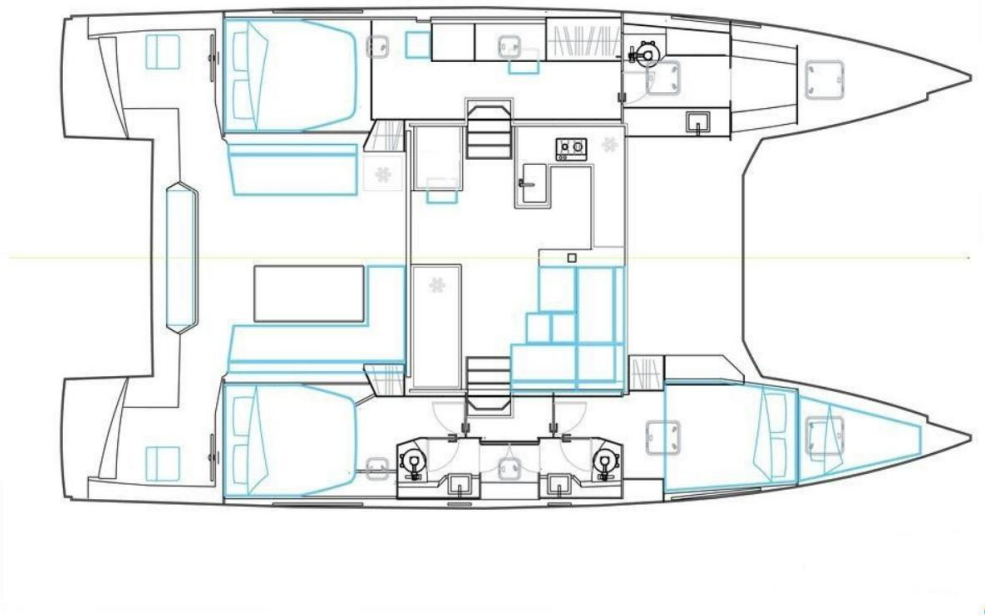

Mechanical and Rigging

CONSTRUCTION

- Nautitech 46 Open Catamaran Year Built: 2018
- Version: 3-cabin owner
- Flag: B.V.I.
- VAT status Net / VAT unpaid
- Model / hull 46 Open / #63
- Type : Sailing Catamaran

DIMENSIONS

- Length: 45.20 feet (13.78 m)
- Width: 7.54 m
- Draft (maximum): 1.45 m
- Displacement: 10 800.00 kg
- Material(s): Polyester Sandwich
- Architect: Marc Lombard

MECHANICAL

- Engines: 2 Volvo D2-50 50.00 hp 500 hours
- Generator Cummins ONAN 7kW- 423 hours
- Type of fuel: Diesel
- Drive Type- Sail drive
- Propeller(s): Volvo 3 blade fixed
- Fuel Type- Diesel

TANKAGE

- Fuel tank: 600.00 L
- Water tank: 600.00 L
- Black waters tank: (2x 60) 120.00 L
- Grey water tanks 2 x 10L auto discharge
- 60 L water heater with upgraded heating element.
- Pressurized hot and cold water
- Watermaker 100 L / hr- Dessolator duo

ELECTRICAL

- Victron Energy LiFePO4 Batteries (2 x 300Ah, total 600Ah)
- Victron MultiPlus Inverter/Charger (12/3000/120-50)
- Solar panels: 2 x 300W and 3 x 330W (1590W total) with Victron MPPT controllers

- 115A alternators on each engine
- Shore power inlet with 20m cable (32, 16, and 10A adaptors)

COMFORT

- Reversible air conditioning (40,000 BTU)
- Mosquito screens for all hatches
- Fans: 12V (1 per cabin, 2 in saloon)
- 12V plugs in cabins and saloon
- Dimmable LED ceiling lights in cabins and companionways
- Washing/drying machine (5kg)
- Warm water boiler (60L, engine and shore power)

RIGGING

- Sloop rig with aluminium mast and boom (2 spreader fractional rig)
- Stainless steel standing rigging (2018)
- Running rigging in excellent condition
- Facnor furling system

SAILS

- Hydranet fully battened mainsail (75m², 3 reefs, lazy bag)
- Hydranet self-tacking jib (38m²)
- Gennaker (98m²) on furling system with bowsprit
- 2 x electric winches

NAVIGATION

- B&G Navigation Suite:
 - 2 x Zeus 7" Chartplotters (helm stations)
 - 1 x Zeus 9" Chartplotter (nav station)
 - Radar, AIS, Autopilot, and wireless VHF

DECK

- ROCNA Vulcan 33kg anchor with 70m of 10mm chain
- Secondary mooring: Delta 25kg with 20m chain and 50m rope
- Quick 1500W windlass with remote control and chain counter
- Foredeck lounge with convertible cushions
- Helm station protection (Sunbrella)
- Deck shower (hot/cold)

SAFETY

- Liferaft for 8 persons
- EPIRB and Iridium satellite phone

ACCOMMODATION

- Owner's suite: Large aft bed, desk, and cupboard in the port hull
- Two guest cabins in the starboard hull, both with ensuite facilities
- Central shower area with washbasin and electric toilets (freshwater flush)

SALON/GALLEY

- Top-loading fridge (85L)

- Dual-drawer fridge (182L)
- Eno 3-burner hob and Corian countertops
- Cockpit enclosure and sunshades for enhanced comfort

Inventory

SPARS & RIGGING

- Type of Rig- Sloop
- Standing Rigging - age- 2018
- AG aluminium mast and boom 2 spreader fractional rig
- Stainless steel standing rigging
- Running Rigging- Good condition
- Facnor furling system

SAILS

- Full batten mainsail 3 reefs with lazy bag and lazy jack
- Furling jib auto-tack with UV tapes (NEW LAZY BAG 2022).
- Hydranet mainsail 75m2 fully battened 3 reefs
- Hydranet self taking jib 38m2 on furler
- Gennaker 98m2 , top down on furling system with bowsprit
- Bow sprit & furler,tack line,dynema halyard
- Deckware (for Genaker or Code 0)
- 2 x electric winches

NAVIGATION

- 2 x B&G Triton Displays (1 per helmstation) with Speed, Depth, Wind-Transducer B&G Autopilot and control unit (stb helmstation)
- B&G V90 VHF incl. Antenna (nav station)
- 2 x B&G Zeus 7" Chartplotter (1 per helmstation)
- 1 x B&G Zeus 9" Chartplotter (nav station)
- B&G AIS Receiver/Transmitter
- B&G H50 Wireless VHF unit (stb helmstation) B&G Radar Antenna

DECK

ANCHOR AND MOORING

- ROCNA - Vulcan - Anchor 33kg with 70m of chain 10mm (grade 70) with crow's feet and chain hook
- Second mooring : Delta 25kg with 20m of chain 10mm and 50m of anchor rope 18mm
- 70m of 8mm G70 galvanised chain.
- Quick 1500W windlass with remote, chain counter and additional remote at Starboard Helm Station
- 8m bridle with Mantus SS chain lock
- 6 x 30cm mooring cleats and 6 x 10m mooring lines
- 8x F6 fenders and 2x A3 ball fenders

EXTERIOR:

- Foredeck Lounge : Bar/storage box for front
- deck lounge with integrated cupholders +
- Foldable 3 parts cushions convertible into lounge area
- Helm station protection (Sunbrella, Cadet Grey) x2 Cushions for cockpit seats and aft bench
- Deck shower hot & cold
- Swim ladder

DECK

ANCHOR AND MOORING

- ROCNA - Vulcan - Anchor 33kg with 70m of chain 10mm (grade 70) with crow's feet and chain hook
- Second mooring : Delta 25kg with 20m of chain 10mm and 50m of anchor rope 18mm
- 70m of 8mm G70 galvanised chain.
- Quick 1500W windlass with remote, chain counter and additional remote at Starboard Helm Station
- 8m bridle with Mantus SS chain lock
- 6 x 30cm mooring cleats and 6 x 10m mooring lines
- 8x F6 fenders and 2x A3 ball fenders

EXTERIOR:

- Foredeck Lounge : Bar/storage box for front
- deck lounge with integrated cupholders +
- Foldable 3 parts cushions convertible into lounge area
- Helm station protection (Sunbrella, Cadet Grey) x2 Cushions for cockpit seats and aft bench
- Deck shower hot & cold
- Swim ladder

SAFETY

- Safety Pack for 8 crew with liferaft

Accommodation

Port hull: Owner's suite, large aft bed, desk and cupboard

Large forward shower room with washbasin, shower and electric toilet fresh water with 85 L holding tank

Starboard hull: Forward double cabin, Aft double cabin

Starboard forepeak equipped for two people:

Extra berth in starboard forepeak incl. mattress, gelcoat finishing, ventilation, light

and access to front cabin

2 shower rooms with washbasin, shower and 1 electric toilet fresh water with 85 L holding tanks and 1 sea water toilet.

Central shower between the 2 shower rooms

INTERIOR

Foldable & lowerable dinner / coffee table

freshwater flush- 2 pcs

Mosquito screens for all hatches on deck

Fans 12V (1 per cabin and 2 in saloon)

Reversible Air-condition 40.000 BTU / 230V (cooling / heating function / outlet in saloon and each cabin)

Electrical toilet freshwater flush*2 + 1 manual toilet

SALOON / GALLEY

- Top loading fridge, 85L in galley 2 drawer Fridge, 182L portside Double sink with mixer
- Eno 3-burner hob Eno
- Corian bench tops
- Saloon and settees to starboard Opening of the sliding door with 2 fronts
- Cockpit enclosure with door (Sunbrella, Cadet Grey)
- Additional sun net for cockpit enclosure
- External sunshades for saloon windscreen (white batyline)
- Hot water Immersion -Engine and shore power, 60L

- Flush 2 drawer stainless steel Fridge 104L / Freezer 78L

ENTERTAINMENT

- FUSION Marine Basis including AM/FM, 2 speakers in saloon and 2 speakers in cockpit, Bluetooth and USB
- TV- 32 inch Samsung smart tv
- TV – antenna

HEADS

2 x Electrical fresh water flush toilets

1x Manual pump salt water flush toilet

Master cabin large shower, Starboard cabins have ensuite heads with a single central shower room.

Lighting

LED navigation, steaming and anchor lights

LED Fordeck spotlight and spreader widefield lights

Overhead dimable LED strip lights Salon, cockpit, each cabin and Starboard hull companionway

CABINS / HEADS

Wood finish at bed front in all cabins

**All double cabin with upgraded mattress Luxury cold foam mattress with memory top

Drawer under bed in all cabins, extra shelves in the closet Opening porthole in aft cabins above bed heads

Blinds for hull windows

Stainless steel handrail at companionway

Remarks :

The Nautitech 46 Open Owners Version (2018) is a pristine sailing catamaran that combines performance with luxury. Just reduced , this owner's version presents an outstanding opportunity for serious sailors seeking a fully-equipped bluewater cruiser.

Highlights (full specifications below):

- Single private owner with meticulous maintenance
- Premium upgrades including luxury mattresses
- Masthead camera for enhanced visibility
- Rocna-Vulcan 33kg anchor
- Onan 7kW generator
- Advanced Victron Energy charging system
- New lazy bag (2022)
- Climate control throughout all spaces

The Nautitech 46 Open combines innovative design with practical sailing features. Its open-concept layout merges indoor and outdoor spaces through large sliding windows, creating living space comparable to a modern apartment. Twin helm stations offer excellent visibility and control.

This three-cabin version features a luxurious owner's suite in the port hull with ensuite facilities, making it ideal for both Med. cruising and ocean passages.

This yacht represents exceptional value, maintained to the highest standards and ready for her next adventure.

Contact: Network Yacht Brokers Lefkas Cleopatra Marina Preveza 48100 Ionian Islands
Greece

Tel: UK+ 44 203 051 0525 / Mob.+306945347870

Email: info@nyblefkas.com